

FLOORPLAN

Borrower: CORY & MARA STILLMAN	File No.: THEREGISTRY
Property Address: 1128 STONE KIRK DRIVE	Case No.:
City: RALEIGH	State: NC
Lender: LINDA CRAFT AND TEAM	Zip: 27614-

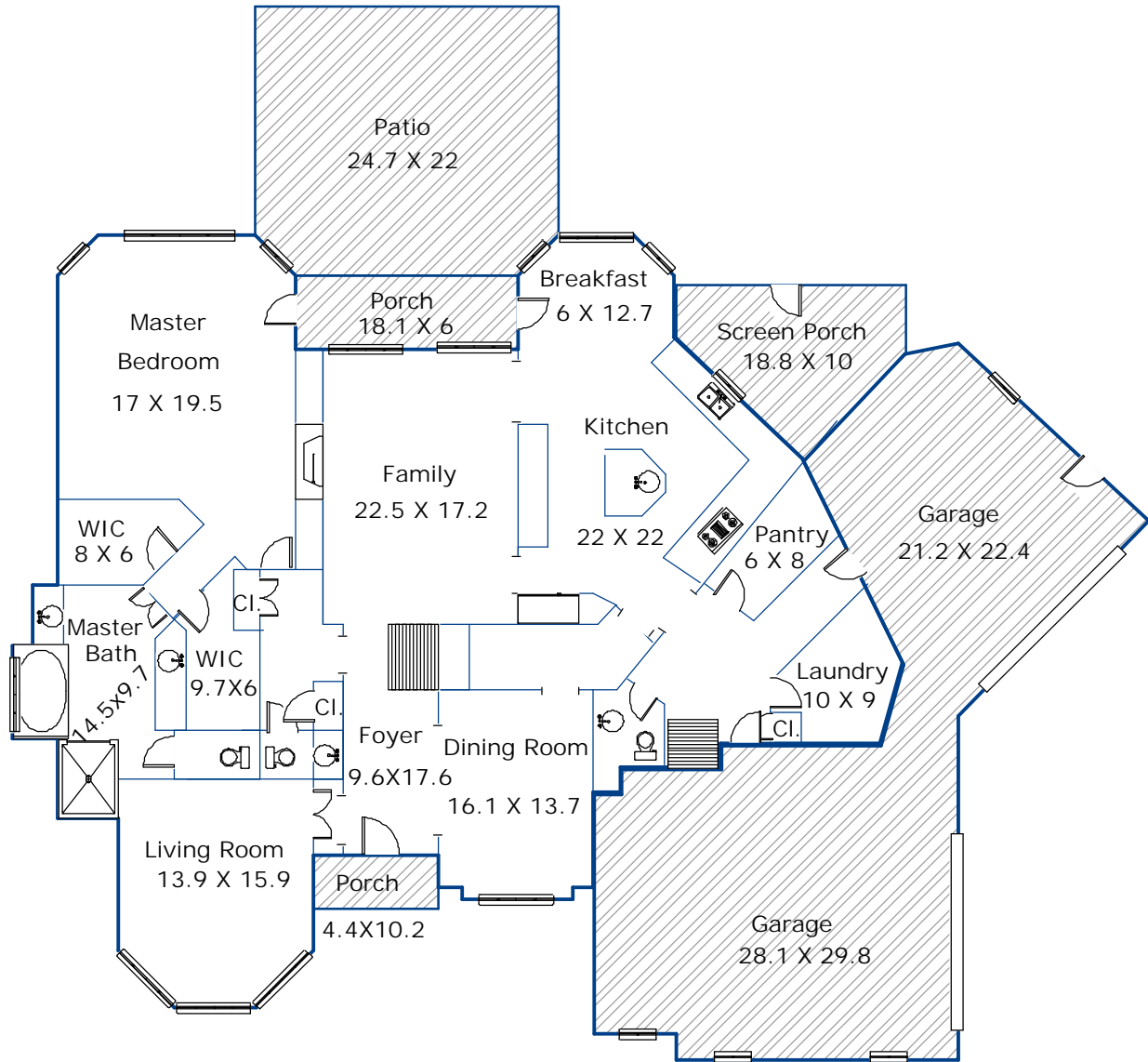

FIRST FLOOR = 2977 SQUARE FEET
 SECOND FLOOR = 2219 SQUARE FEET
 TOTAL FINISHED = 5196 SQUARE FEET
 Garage = 1218 SQUARE FEET

Sketch by Apex Medina™

FLOORPLAN

Borrower: CORY & MARA STILLMAN	File No.: THEREGISTRY	
Property Address: 1128 STONE KIRK DRIVE	Case No.:	
City: RALEIGH	State: NC	Zip: 27614-
Lender: LINDA CRAFT AND TEAM		

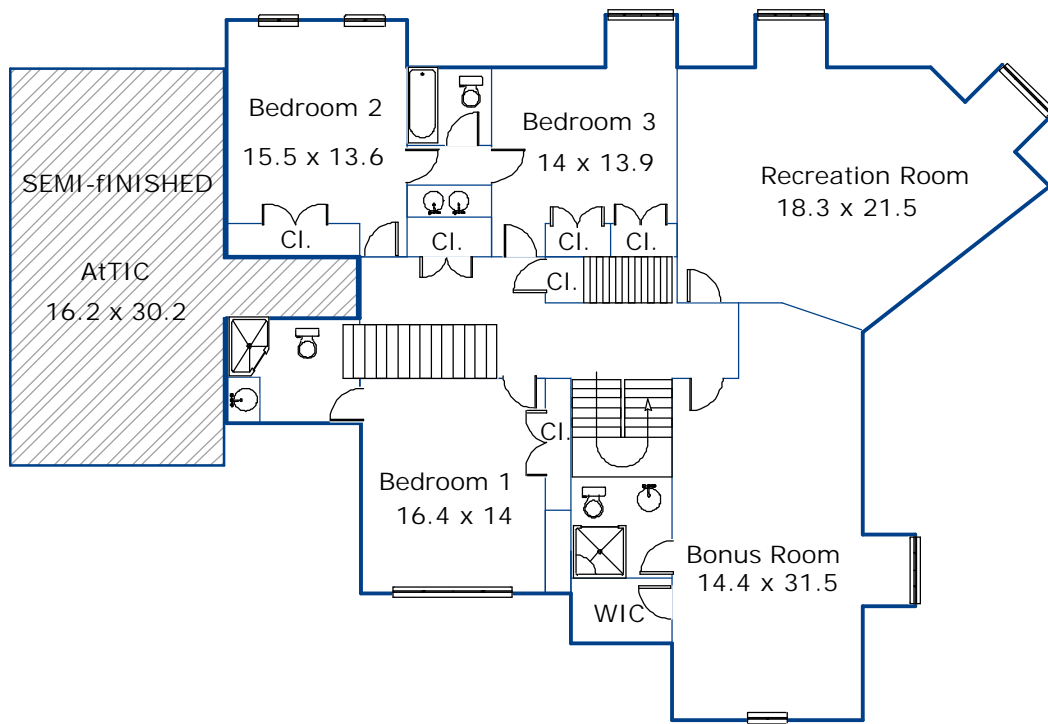

Sketch by Apex Medina™

FLOORPLAN

Borrower: CORY & MARA STILLMAN

File No.: THEREGISTRY

Property Address: 1128 STONE KIRK DRIVE

Case No.:

City: RALEIGH

State: NC

Zip: 27614

Lender: LINDA CRAFT AND TEAM

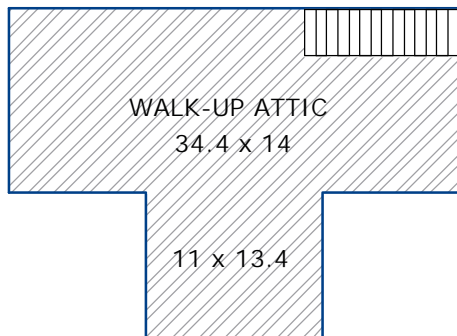

Sketch by Apex Medina™

FLOORPLAN

Borrower: CORY & MARA STILLMAN		File No.: THEREGISTRY	
Property Address: 1128 STONE KIRK DRIVE		Case No.:	
City: RALEIGH	State: NC	Zip: 27614-	
Lender: LINDA CRAFT AND TEAM			

AREA CALCULATIONS SUMMARY			
Code	Description	Net Size	Net Totals
GLA1	First Floor	2977.2	2977.2
GAR	Garage	1218.4	1218.4
OTH	porch	44.9	
	porch	108.6	
	Patio	532.5	
	SCREEN PORCH	179.8	865.8
GLA1	second floor	2218.9	2218.9
OTH	Semi-Finished Attic	535.7	
	ATTIC	629.0	629.0
Net LIVABLE Area		(rounded)	5196

LIVING AREA BREAKDOWN			
Breakdown			Subtotals
First Floor			
0.5 x	1.3 x	0.6	0.4
0.5 x	1.7 x	6.3	5.4
	5.0 x	67.9	339.4
	72.0 x	1.3	93.5
	2.0 x	54.1	108.2
0.5 x	0.1 x	0.3	0.0
	70.9 x	6.3	446.6
	10.3 x	60.8	626.2
0.5 x	5.0 x	2.5	6.2
	2.0 x	46.0	92.0
	67.2 x	0.3	20.2
0.5 x	3.3 x	3.3	5.4
	6.0 x	19.5	117.0
	6.0 x	12.7	76.2
	9.0 x	51.3	462.2
0.5 x	10.3 x	5.1	26.2
	2.2 x	43.7	96.1
	12.9 x	3.3	42.6
0.5 x	3.3 x	3.3	5.4
0.5 x	1.0 x	1.0	0.5
0.5 x	9.0 x	9.5	42.5
	1.0 x	9.0	9.0
32 Items Not Listed			2574.8
54 Items			(rounded) 5196

First Floor		GLA1	
0.5 x	1.3 x	0.6 =	0.4
0.5 x	1.7 x	6.3 =	5.4
	5.0 x	67.9 =	339.4
	72.0 x	1.3 =	93.5
	2.0 x	54.1 =	108.2
0.5 x	0.1 x	0.3 =	0.0
	70.9 x	6.3 =	446.6
	10.3 x	60.8 =	626.2
0.5 x	5.0 x	2.5 =	6.2
	2.0 x	46.0 =	92.0
	67.2 x	0.3 =	20.2
0.5 x	3.3 x	3.3 =	5.4
	6.0 x	19.5 =	117.0
	6.0 x	12.7 =	76.2
	9.0 x	51.3 =	462.2
0.5 x	10.3 x	5.1 =	26.2
	2.2 x	43.7 =	96.1
	12.9 x	3.3 =	42.6
0.5 x	3.3 x	3.3 =	5.4
12 unlisted calculations		=	407.9
Area total (rounded)		=	2977

Garage		GAR	
0.5 x	0.9 x	4.4 =	2.0
	8.8 x	5.4 =	47.2
0.5 x	1.0 x	0.9 =	0.4
0.5 x	2.4 x	4.8 =	5.7
0.5 x	8.8 x	8.3 =	36.5
0.5 x	9.4 x	8.8 =	41.4
	4.2 x	4.5 =	18.9
0.5 x	5.8 x	11.8 =	34.4
	20.7 x	4.8 =	99.3
	19.4 x	2.0 =	38.8
	2.4 x	5.6 =	13.5
0.5 x	4.2 x	1.1 =	2.4
0.5 x	4.2 x	4.1 =	8.5
	8.6 x	11.8 =	101.1
0.5 x	5.1 x	4.8 =	12.3
	27.5 x	2.0 =	55.0
0.5 x	2.4 x	0.7 =	0.8
0.5 x	11.8 x	11.4 =	67.4
	29.8 x	19.6 =	584.1
1 unlisted calculations		=	48.5
Area total (rounded)		=	1218

porch		OTH	
10.2 x	4.4 =	44.9	
Area total (rounded)		=	45

porch		OTH	
6.0 x	18.1 =	108.6	
Area total (rounded)		=	109

FLOORPLAN

Borrower: CORY & MARA STILLMAN	File No.: THEREGISTRY
Property Address: 1128 STONE KIRK DRIVE	Case No.:
City: RALEIGH	State: NC
Lender: LINDA CRAFT AND TEAM	Zip: 27614-

Patio	OTH
3.3 x	18.1 = 59.7
18.7 x	24.7 = 461.9
0.5 x 3.3 x	3.3 = 5.4
0.5 x 3.3 x	3.3 = 5.4

Area total (rounded) = 533

SCREEN PORCH	OTH
18.8 x	4.3 = 80.8
0.5 x 8.3 x	8.8 = 36.5
0.5 x 1.2 x	17.5 = 21.0
0.5 x 8.8 x	9.2 = 40.7
0.5 x 1.2 x	1.3 = 0.8

Area total (rounded) = 180

second floor	GLA1
0.5 x 1.4 x	1.1 = 0.8
4.6 x	39.5 = 181.7
8.0 x	48.2 = 385.6
42.1 x	4.5 = 189.4
8.5 x	38.1 = 323.9
0.5 x 6.9 x	5.4 = 18.7
0.5 x 5.9 x	4.6 = 13.5
2.9 x	22.1 = 64.1
0.9 x	26.1 = 23.5
3.6 x	13.6 = 49.0
4.0 x	5.4 = 21.6
4.0 x	5.4 = 21.6
0.5 x 2.8 x	2.8 = 3.9
2.6 x	53.4 = 138.8
1.0 x	61.6 = 61.6
5.4 x	59.8 = 322.9
55.5 x	5.4 = 299.7
5.8 x	14.4 = 83.5
0.5 x 2.8 x	2.8 = 3.9
4 unlisted calculations = 11.2	

Area total (rounded) = 2219

Semi-Finished Attic	OTH
16.2 x	14.4 = 233.3
26.3 x	4.6 = 121.0
11.2 x	16.2 = 181.4

Area total (rounded) = 536

ATTIC	OTH
34.4 x	14.0 = 481.6
11.0 x	13.4 = 147.4

Area total (rounded) = 629